

# AMERICAN MOTORS PARTS CATALOG

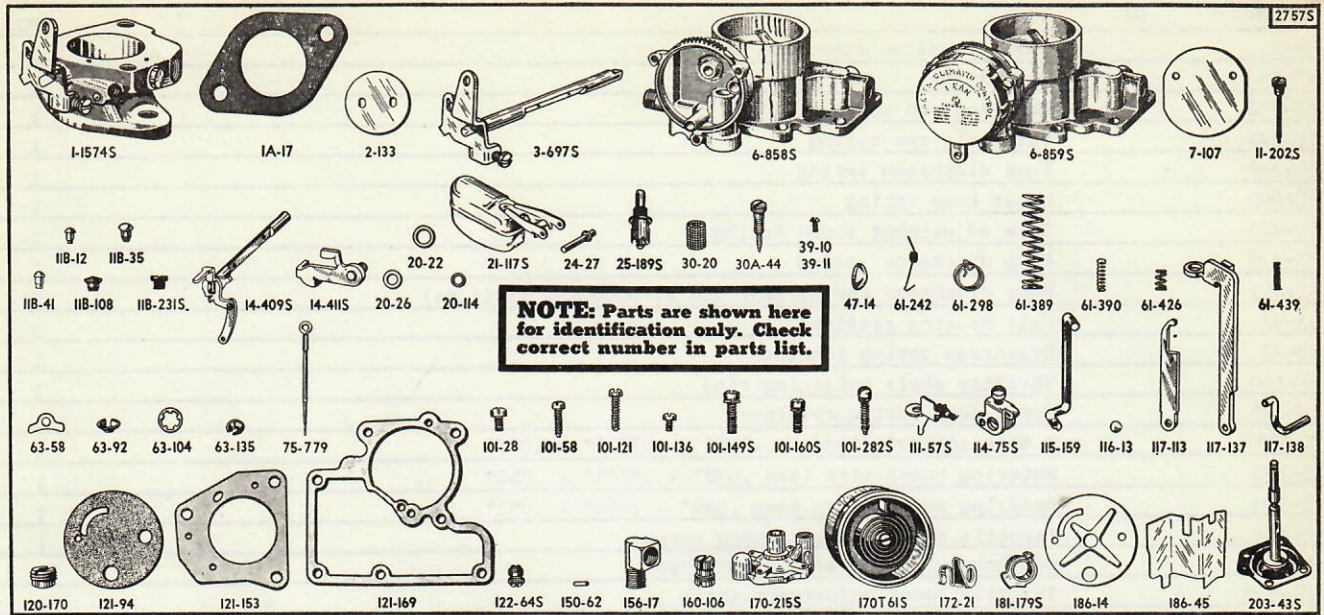

## CARBURETOR 59 01

A.M.C. 315 4345

CARTER NO. WCD-2014S, WCD-2757S

CARTER No.	A.M.C. No.	DESCRIPTION	QUAN. REQ.
	320 2176	Zip fit carburetor (Skeleton)	1
	320 2174	Zip kit (Includes 109-332 Float Gauge and all parts listed below which are coded with a #)	1
	320 2239	Repair kit (Includes all parts listed below which are coded with a *)	1
	320 2255	# Gasket set (Includes all parts listed below which are coded with a +)	1
1-1574S		Body flange assembly (2757S)	1
1-847S		Body flange assembly (2014S)	1
1A-17	315 3999	*+ Flange gasket	2
2-133		Throttle valve	1
3-697S		Throttle shaft and lever assembly	1
6-858S		Air horn and climatic control assembly	1
6-859S		Air horn assembly	1
7-107		Choke valve	1
11-202S		Low speed jet assembly (.028")	1
11B-12		Flange passage plug	1
11B-35		Nozzle passage rivet plug	1
11B-41		Rivet Plug	1
11B-108		Idle port rivet plug	1
11B-231S		Ball retainer screw plug assembly	1
14-409S		Choke piston lever and shaft assembly	1
14-411S		Choke trip lever and pin assembly	1
20-22		+ Needle seat gasket	1
20-26		+ Ball retainer screw plug gasket	1
20-114		Diaphragm housing attaching screw gasket	1
21-117S	320 2231	Float and lever assembly	1
24-27		Float lever pin	1
25-189S	320 2233	#+ Needle and seat assembly (.076")	1
30-20		Pump intake strainer	1
30A-44	320 2229	Idle adjustment screw	1
39-10		Choke valve attaching screw	2



# AMERICAN MOTORS PARTS CATALOG

CARTER No.	A.M.C. No.	DESCRIPTION	QUAN. REQ.
39-11		Throttle valve attaching screw	2
47-14		Welsh plug	1
61-242		Metering rod spring	1
61-298		Fast idle cam spring	1
61-389		Pump diaphragm spring	1
61-390		Upper pump spring	1
61-426		Idle adjustment screw spring	1
61-439		Pump discharge spring	1
61-451		Pump diaphragm spring (For use at 5000 ft. Altitude)	1
63-58		Coil housing retainer	3
63-92		Diaphragm spring retainer	1
63-104		Throttle shaft retaining ring	1
63-135		Upper pump spring retainer	1
75-779		* Metering rod-standard .078" x .07325" x .047"	1
75-793		Metering rod-1 size lean .078" x .0745" x .050"	1
75-794		Metering rod-2 sizes lean .080" x .076" x .053"	1
101-28		Throttle shaft arm attaching screw	1
101-58		Diaphragm housing attaching screw	1
101-121		Throttle lever adjustment screw	1
101-136		Coil housing attaching screw	3
101-149S		Body flange attaching screw and washer assembly	3
101-160S		Air horn attaching screw and washer assembly	7
101-282S		Diaphragm housing attaching screw and washer assembly	3
111-57S		Metering rod arm assembly	1
114-75S		Throttle shaft arm assembly	1
115-159		Choke connector rod	1
116-13		Pump check ball	1
117-113		Fast idle link	1
117-137		Pump lifter link	1
117-138		Pump connector link	1
120-170		* Metering rod jet (.102")	1
121-94		** Thermostatic coil housing gasket	1
121-153		** Body flange gasket	1
121-169		** Bowl cover and air horn gasket	1
122-64S		Intake ball check assembly	1
150-62		Choke piston pin	1
156-17		Fuel line elbow	1
160-106		Choke piston	1
170-215S		Pump diaphragm housing assembly	1
170T-61S		Thermostatic coil and housing assembly	1
172-21		Throttle connector rod retainer	1
186-14		Coil housing baffle plate	1
186-45		Fuel bowl baffle plate	1
203-43S	320 2236	## Pump diaphragm assembly	1



# AMERICAN MOTORS PARTS CATALOG

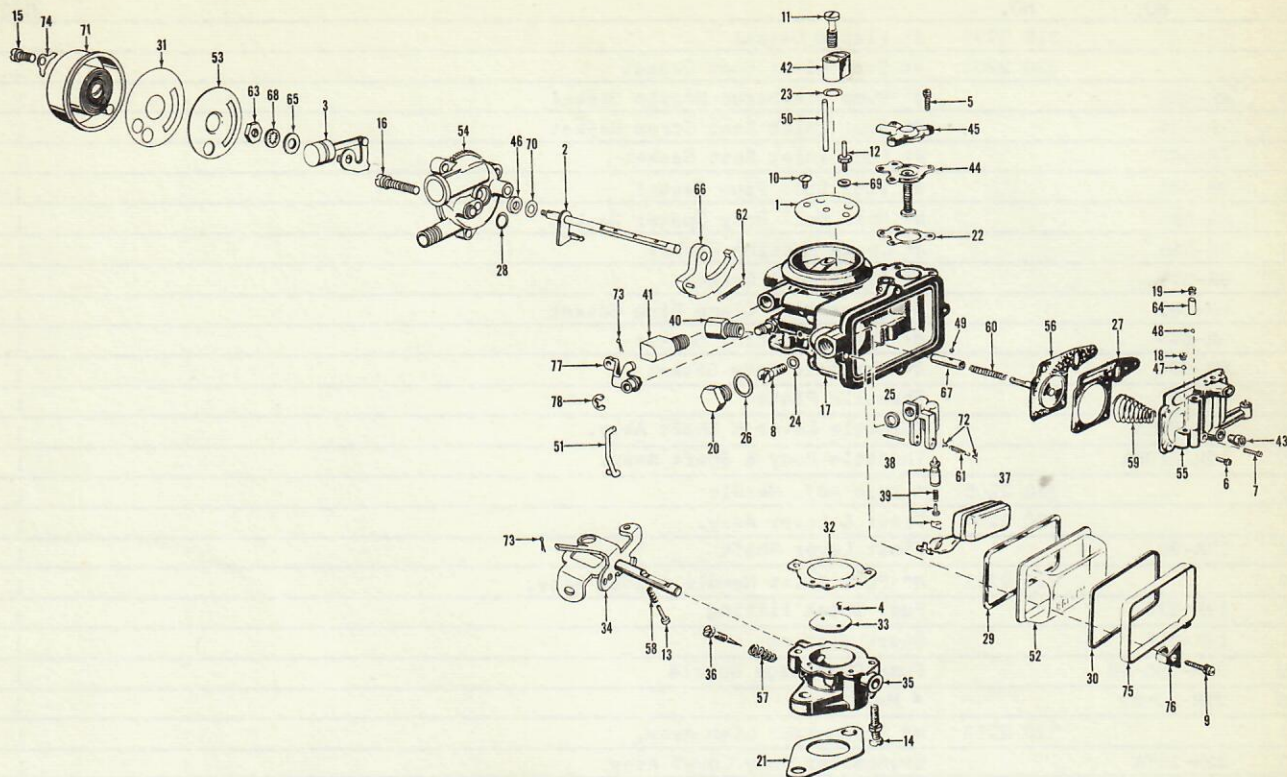

## CARBURETOR 59 10 (LDT)

A.M.C. No. 315 6267

HOLLEY NO. R-1598A

KEY NO.	HOLLEY NO.	A.M.C. NO.	DESCRIPTION	QUAN. REQ.
		320 2225	Pep Kit (Includes all parts listed below which are coded with a #)	1
		320 2224	Repair Kit (Includes all parts listed below which are coded with a *)	1
		320 2221	* Gasket Set (Includes all parts listed below which are coded with a +)	1
1	2R-191		Choke Plate	1
2	3R-305A		Choke Shaft & Lever Assy.	1
3	4R-637A		Choke Therm. Lever Link & Piston	1
4	5R-4		* Throttle Plate Screw	2
5	5R-641		Economizer Body Screw & L.W.	3
6	5R-420		Main Well & Econ. Body Screw & L.W. Short	3
7	5R-421		Main Well & Econ. Body Screw & L.W. Long	2
8	5R-423		Fuel Inlet Seat Screw	1
9	5R-425		Float Bowl Clamp Screw & L.W.	4
10	5R-491		* Choke Plate Screw	1
11	5R-492		Pump Discharge Nozzle Screw	1
12	5R-510		Choke Plate Screw	1
13	5R-534		Throttle Stop Screw	1
14	5R-571		Throttle Body Screw & L.W.	2
15	5R-731		Therm. Housing Screw	3
16	5R-732		Choke Housing Screw & L.W.	2
17	6R-1867A		Main Body & Plugs Assy.	1
18	7R-48-3		Inlet Ball & Discharge Valve Retainer	1
19	7R-48-3		Inlet Ball & Discharge Valve Retainer	1
20	7R-255		Fuel Inlet Plug	1



# AMERICAN MOTORS PARTS CATALOG

KEY NO.	HOLLEY NO.	A.M.C. NO.	DESCRIPTION	QUAN. REQ.
21		315 3999	#+ Flange Gasket	1
22		320 2203	#+ Economizer Body Gasket	1
23	8R-538		#+ Pump Discharge Nozzle Gasket	1
24	8R-539		#+ Fuel Inlet Seat Screw Gasket	1
25	8R-540		#+ Fuel Inlet Seat Gasket	1
26	8R-541		#+ Fuel Boss Plug Gasket	1
27	8R-545		#+ Main Well Body Spacer Gasket	1
28	8R-568		#+ Choke Housing Gasket	1
29	8R-579		#+ Float Bowl Gasket	1
30	8R-582		#+ Float Bowl Clamp Ring Gasket	1
31	8R-644		#+ Therm. Housing Gasket	1
32	8R-800		#+ Throttle Body Gasket	1
33	9R-70		Throttle Plate	1
34	10R-755A		Throttle Lever & Shaft Assy.	1
35	12R-2198A		Throttle Body & Shaft Assy.	1
36		320 2205	* Idle Adj. Needle	1
37		320 2207	Float & Lever Assy.	1
38	17R-20		Float Lever Shaft	1
39		320 2211	#* Fuel Inlet Needle & Seat Assy.	1
40	19R-223		Fuel Inlet Fitting	1
41	19R-219		Spark Fitting	1
42	21R-355-28		Pump Discharge Nozzle	1
43	22R-40-59		* Main Jet	1
44		320 2213	#* Economizer Stem Assy.	1
45	25R-167A		Economizer Body Cover Assy.	1
46	27R-204		#+ Choke Shaft Seal	1
47	28R-6		* Pump Inlet Ball	1
48	28R-94		* Pump Discharge Ball	1
49	28R-94		* Pump Push Rod Ball	1
50	29R-339		Distribution Pin	1
51	33R-344		* Pump Oper. Link	1
52	34R-905		Float Bowl	1
53	34R-1300		Choke Housing Plate	1
54	34R-2252A		Choke Housing & Plugs Assy.	1
55	34R-2379A		Main Well & Econ. Body & Plugs Assy.	1
56		320 2219	#* Pump Diaphragm & Rod Assy.	1
57	38R-108		Idle Adj. Needle Spring	1
58	38R-110		Throttle Stop Screw Spring	1
59	38R-395		Pump Return Spring	1
60	38R-452		Pump Oper. Spring	1
61	38R-566		Float Bumper Spring	1
62	38R-759		Choke Lever Spring	1
63	39R-5		Choke Shaft Nut	1
64	40R-283		Pump Discharge Valve Weight	1
65	40R-368		Choke Therm. Lever Spacer	1
66	41R-276A		Fast Idle cam Assy.	1
67	42R-112		Pump Push Rod Sleeve	1
68	46R-248		Choke Shaft Nut L.W.	1
69	46R-399		Choke Plate Screw L.W.	1
70	46R-529		Choke Shaft Seal Washer	1
71	47R-126A		Therm. Housing Assy. Complete	1
72	48R-5		Float Bumper Spring Retainer	2
73	48R-183		* Pump Oper. Link Retainer	2
74	49R-128		Therm. Housing Clamp	3
75	49R-187		Float Bowl Clamp Ring	1
76	49R-250		Float Bowl Clamp	4
77	63R-233A		Pump Oper. Lever Assy.	1
78	75R-37		* Pump Oper. Lever Retainer	1



# AMERICAN MOTORS PARTS CATALOG

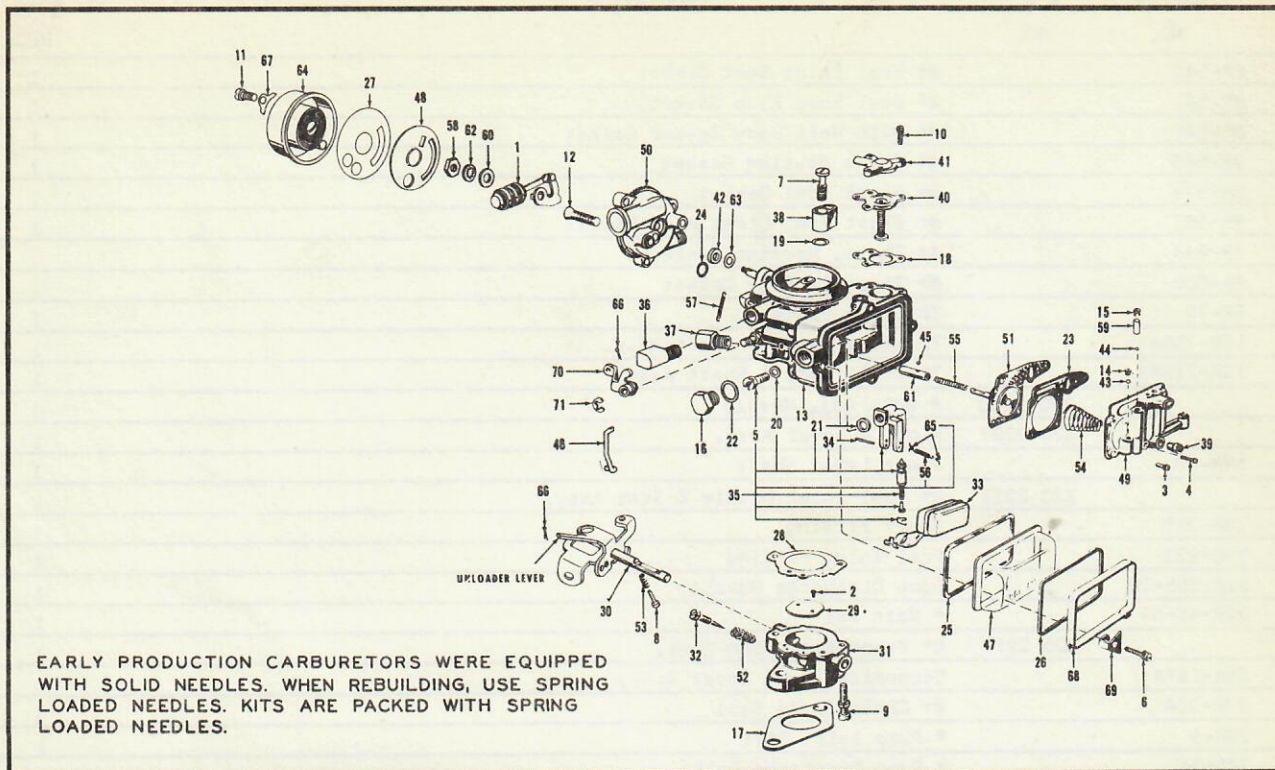

CARBURETOR 59 10 (LDT)

A.M.C. No. 315 7563

HOLLEY NO. R-1598-1A

KEY NO.	HOLLEY NO.	A.M.C. NO.	DESCRIPTION	QUAN. REQ.
		320 2225	Pep Kit (Includes all parts listed below which are coded with a #)	1
		320 2224	Repair Kit (Includes all parts listed below which are coded with a *)	1
		320 2221	* Gasket Set (Includes all parts listed below which are coded with a +)	1
1	4R-648A		Choke Therm. Lever Link & Piston	1
2	5R-4		* Throttle Plate Screw	2
3	5R-420		Main Well & Econ. Body Screw & L.W. Short	3
4	5R-421		Main Well & Econ. Body Screw & L.W. Long	2
5	5R-423		Fuel Inlet Seat Screw	1
6	5R-425		Float Bowl Clamp Screw & L.W.	4
7	5R-492		Pump Discharge Nozzle Screw	1
8	5R-534		Throttle Stop Screw	1
9	5R-571		Throttle Body Screw & L.W.	2
10	5R-641		Economizer Body Screw & L.W.	3
11	5R-731		Therm. Housing Screw	3
12	5R-757		Choke Housing Screw & L.W.	2
13	6R-1947A		Main Body & Plugs Assy.	1
14	7R-48-3		Inlet Ball Retainer	1
15	7R-48-3		Discharge Valve Retainer	1
16	7R-255		Fuel Inlet Plug	1
17		315 3999	#+ Flange Gasket	1
18		320 2203	#+ Economizer Body Gasket	1
19	8R-538		#+ Pump Discharge Nozzle Gasket	1
20	8R-539		+ Fuel Inlet Seat Screw Gasket	1



# AMERICAN MOTORS PARTS CATALOG

KEY NO.	HOLLEY NO.	A.M.C. NO.	DESCRIPTION	QUAN. REQ.
21	8R-540		#+ Fuel Inlet Seat Gasket	1
22	8R-541		#+ Fuel Boss Plug Gasket	1
23	8R-545		#+ Main Well Body Spacer Gasket	1
24	8R-568		#+ Choke Housing Gasket	1
25	8R-579		#+ Float Bowl Gasket	1
26	8R-582		#+ Float Bowl Clamp Ring Gasket	1
27	8R-644		#+ Therm. Housing Gasket	1
28	8R-800		#+ Throttle Body Gasket	1
29	9R-70		Throttle Plate	1
30	10R-755A		Throttle Lever & Shaft Assy.	1
31	12R-2198A		Throttle Body & Shaft Assy.	1
32		320 2205	* Idle Adj. Needle	1
33		320 2207	Float & Lever Assy.	1
34	17R-20		Float Lever Shaft	1
35		320 2211	** Fuel Inlet Needle & Seat Assy.	1
36	19R-219		Spark Fitting	1
37	19R-223		Fuel Inlet Fitting	1
38	21R-355-28		Pump Discharge Nozzle	1
39	22R-40-59		* Main Jet	1
40		320 2213	** Economizer Stem Assy.	1
41	25R-167A		Economizer Body Cover Assy.	1
42	27R-204		#+ Choke Shaft Seal	1
43	28R-6		* Pump Inlet Ball	1
44	28R-94		* Pump Discharge Ball	1
45	28R-94		* Pump Push Rod Ball	1
46	33R-344		* Pump Oper. Link	1
47	34R-905		Float Bowl	1
48	34R-2757		Choke Housing Plate	1
49	34R-2379A		Main Well & Econ. Body & Plugs Assy.	1
50	34R-2810A		Choke Housing & Plugs Assy.	1
51		320 2219	** Pump Diaphragm & Rod Assy.	1
52	38R-108		Idle Adj. Needle Spring	1
53	38R-110		Throttle Stop Screw Spring	1
54	38R-395		Pump Return Spring	1
55	38R-452		Pump Oper. Spring	1
56	38R-566		Float Bumper Spring	1
57	38R-759		Choke Lever Spring	1
58	39R-11		Choke Shaft Nut	1
59	40R-283		Pump Discharge Valve Weight	1
61	42R-112		Pump Push Rod Sleeve	1
62	46R-252		Choke Shaft Nut, L.W.	1
63	46R-529		Choke Shaft Seal Washer	1
64	47R-144A		Therm. Housing Assy. Complete	1
65	48R-5		Float Bumper Spring Retainer	1
66	48R-183		* Pump Oper. Link Retainer	1
67	49R-128		Therm. Housing Clamp	1
68	49R-187		Float Bowl Clamp Ring	3
69	49R-250		Float Bowl Clamp	1
70	63R-233A		Pump Oper. Lever Assy.	4
71	75R-37		Pump Oper. Lever Retainer	1



# AMERICAN MOTORS PARTS CATALOG

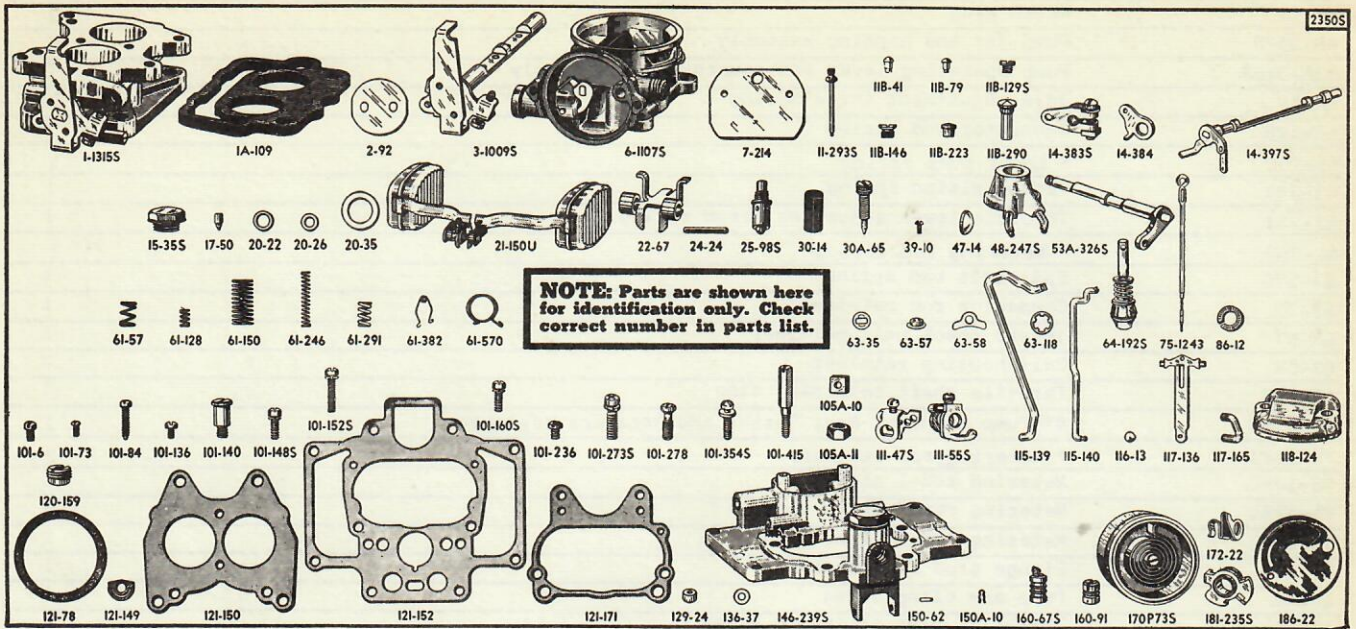

## CARBURETOR 59 10 (WDT)

A.M.C. No. 315 1207

CARTER No. WCD-2350S And WCD-2586S

CARTER No.	A.M.C. No.	DESCRIPTION	QUAN. REQ.
	320 2175	Zip kit (Includes 109-316 float gauge and all parts listed below which are coded with a #)	1
	320 2240	Repair kit (Includes all parts listed below which are coded with a *)	1
	320 2255	# Gasket set (Includes all parts listed below which are coded with a +)	1
1-1315S		Body flange assembly	1
1A-109	315 0679	*+ Flange gasket	1
2-92		Throttle valve	2
3-1009S		Throttle shaft and lever assembly	1
6-1107S		Air horn and plug assembly	1
7-214		Choke valve	1
11-293S		* Low speed jet assembly	2
11B-41		Rivet plug	2
11B-79		Rivet plug	7
11B-129S		* Pump discharge passage plug assembly	1
11B-146		Level sight plug	1
11B-223		Nozzle passage rivet plug	2
11B-290		* Idle port rivet plug	2
14-383S		Choke lever and screw assembly	1
14-384		Cam trip lever	1
14-397S		Choke piston lever, link and shaft assembly	1
15-35S		Strainer nut assembly	1
17-50		* Pump check needle	1
20-22		+ Needle seat gasket	1
20-26		+ Gasket	1
20-35		*+ Bowl strainer gasket	1
21-150U	320 2232	Unitized package (Float Assy.)	1
22-67		Auxiliary float lever	1
24-24		Float lever pin	1
24-29		Float lever pin (Sup. by 24-24)	1
25-98S		## Needle and seat assembly	1
30-14		* Bowl cover strainer	1
30A-65		Idle adjustment screw	2
39-10		Choke valve attaching screw	2



# AMERICAN MOTORS PARTS CATALOG

47-14	Welsh plug	1
48-247S	Pump jet and housing assembly	1
53A-326S	Pump operating lever and countershaft assembly	1
61-57	Idle adjustment screw spring	2
61-128	Connector rod spring	1
61-150	* Lower pump spring	1
61-246	Vacuum piston spring	1
61-291	Throttle lever adjusting screw spring	1
61-382	* Metering rod spring	1
61-570	Fast idle cam spring	1
63-35	Connector rod retainer	1
63-57	Intake check ball retainer	1
63-58	Coil housing retainer	2
63-118	Throttle shaft retaining ring	1
64-192S	## Pump plunger, Rod, Spring and Retainer assembly	1
75-1243	* Metering rod-standard	2
75-1290	Metering rod-1 size lean	2
75-1291	Metering rod-2 sizes lean	2
75-1292	Metering rod-3 sizes lean	2
86-12	Flange stud lock washer	1
101-6	Pump arm clamp screw	1
101-73	Throttle valve attaching screw	4
101-84	Fast idle adjustment screw	1
101-136	Coil housing attaching screw	2
101-140	Fast idle cam attaching screw	1
101-148S	Dust cover attaching screw and washer assembly	2
101-152S	Air horn attaching screw and washer assembly	4
101-160S	Bowl cover attaching screw and washer assembly	6
101-236	Metering rod arm clamp screw	1
101-273S	Body flange attaching screw and washer assembly	4
101-278	Pump jet housing attaching screw	1
101-354S	Choke lever clamp screw and washer assembly	1
101-415	Throttle lever adjusting screw	1
105A-10	Choke lever clamp screw nut	1
105A-11	Flange stud nut	1
111-47S	Pump arm and screw assembly	1
111-55S	Metering rod arm and screw assembly	1
115-139	* Throttle connector rod	1
115-140	Choke connector rod	1
116-13	Ball	1
117-28	Pump connector link (Sup. by 117-165)	1
117-136	Vacumeter piston link	1
117-165	Pump connector link	1
118-124	Dust cover	1
120-159	* Metering rod jet	2
121-78	*+ Coil housing gasket	1
121-149	Pump jet housing gasket (Sup. by 121-241)	1
121-150	*+ Body flange gasket	1
121-152	*+ Bowl cover gasket	1
121-171	*+ Air horn gasket	1
121-241	*+ Pump jet housing gasket	1
129-24	Metering rod disk	2
136-37	Connector rod washer	1
146-239S	Bowl cover and strainer assembly	1
150-62	Piston pin	1
150A-10	* Pin spring	2
160-67S	Vacuum piston and pin assembly	1
160-91	Choke piston	1
170P73S	Thermostatic coil and housing assembly	1
172-22	* Throttle connector rod retainer	1
181-235S	Fast idle cam assembly	1
186-22	Baffle plate	1



# AMERICAN MOTORS PARTS CATALOG

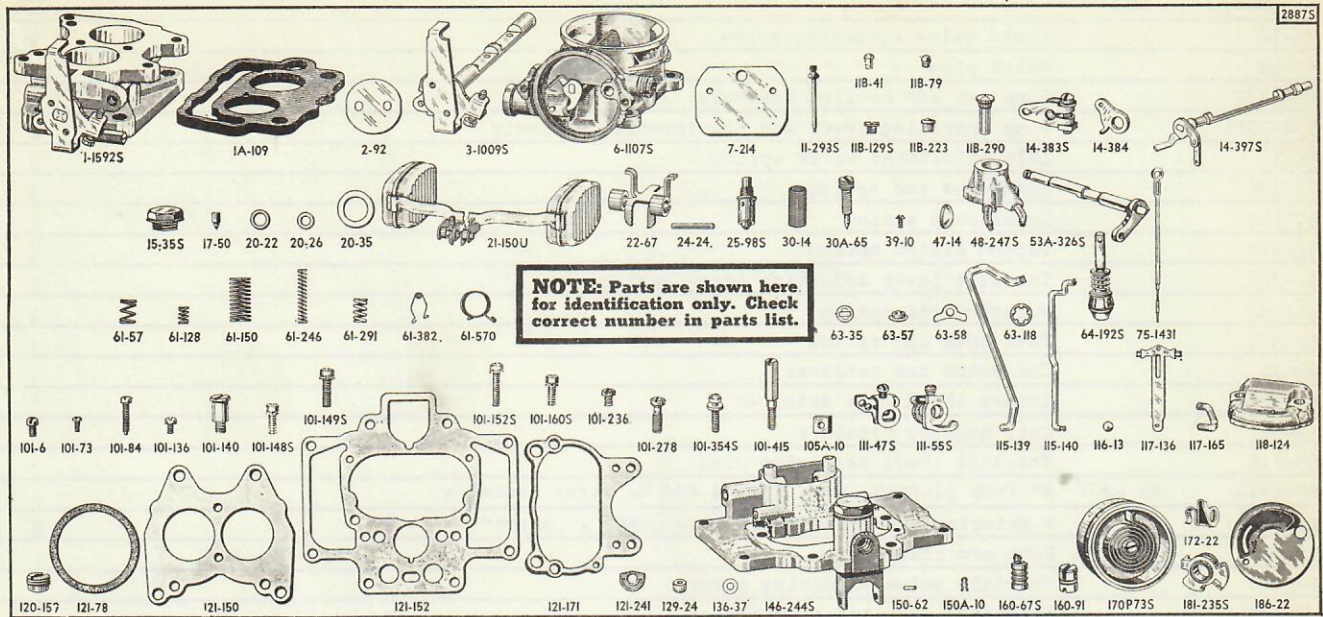

## CARBURETOR 59 10 (WDT)

A.M.C. No. 315 6695

CARTER No. WCD-2887S

CARTER No.	A.M.C. No.	DESCRIPTION	QUAN. REQ.
	320 2175	Zip kit (Includes 109-316 Float gauge and all parts listed below which are coded with a #)	1
	320 2240	Repair kit (Includes all parts listed below which are coded with a *)	1
	320 2238	# Gasket set (Includes all parts listed below which are coded with a +)	1
1-1495S		Body flange assembly	1
1-1592S		Body flange assembly (Use 1-1495S)	1
1A-109	315 0679	*+ Flange gasket	1
2-92		Throttle valve	2
3-1009S		Throttle shaft and lever assembly	1
6-1107S		Air horn and plug assembly	1
7-214		Choke valve	1
11-293S		Low speed jet assembly (.026")	2
11B-41		Rivet plug	2
11B-79		Rivet plug	7
11B-129S		Pump discharge passage plug assembly	1
11B-223		Nozzle passage rivet plug	2
11B-290		Idle port rivet plug	2
14-383S		Choke lever and screw assembly	1
14-384		Cam trip lever	1
14-397S		Choke piston lever, link and shaft assembly	1
15-35S		Strainer nut assembly	1
17-50		Pump check needle	1
20-22		+ Needle seat gasket	1
20-26		+ Gasket	1
20-35		+ Bowl strainer gasket	1
21-150U	320 2232	Unitized package (Float assy.)	1
22-67		Auxiliary float lever	1
24-24		Float lever pin	1
25-98S	320 2235	#* Needle and seat assembly (.1015")	1
30-14		Bowl cover strainer	1
30A-65	320 2230	Idle adjustment screw	2



# AMERICAN MOTORS PARTS CATALOG

CARTER No.	A.M.C. No.	DESCRIPTION	QUAN. REQ.
39-10		Choke valve attaching screw	2
47-14		Welsh plug	1
48-247S		Pump jet and housing assembly	1
53A-326S		Pump operating lever and countershaft assembly	1
61-57		Idle adjustment screw spring	2
61-128		Connector rod spring	1
61-150		Lower pump spring	1
61-246		Vacuum piston spring	1
61-291		Throttle lever adjusting screw spring	1
61-382		Metering rod spring	1
61-570		Fast idle cam spring	1
63-35		Connector rod retainer	1
63-57		Intake check ball retainer	1
63-58		Coil housing retainer	2
63-118		Throttle shaft retaining ring	1
64-192S	320 2237	#* Pump plunger, Rod, Spring and Retainer assembly	1
75-1431		* Metering rod-standard .073" x .068" x .06175"	2
101-6		Pump arm clamp screw	1
101-73		Throttle valve attaching screw	4
101-84		Fast idle adjustment screw	1
101-136		Coil housing attaching screw	2
101-140		Fast idle cam attaching screw	1
101-148S		Dust cover attaching screw and washer assembly	2
101-149S		Body flange attaching screw and washer assembly	4
101-152S		Air horn attaching screw and washer assembly	4
101-160S		Bowl cover attaching screw and washer assembly	6
101-236		Metering rod arm clamp screw	1
101-278		Pump jet housing attaching screw	1
101-354S		Choke lever clamp screw and washer assembly	1
101-415		Throttle lever adjusting screw	1
105A-10		Choke lever clamp screw nut	1
111-47S		Pump arm and screw assembly	1
111-55S		Metering rod arm and screw assembly	1
115-139		Throttle connector rod	1
115-140		Choke connector rod	1
116-13		Ball	1
117-136		Vacumeter piston link	1
117-165		Pump connector link	1
118-124		Dust cover	1
120-159		* Metering rod jet (.089")	2
121-78		*+ Coil housing gasket	1
121-150		*+ Body flange gasket	1
121-152		*+ Bowl cover gasket	1
121-171		*+ Air horn gasket	1
121-241		*+ Pump jet housing gasket	1
129-24		Metering rod disk	2
136-37		Connector rod washer	1
146-244S		Bowl cover and strainer assembly	1
150-62		Piston pin	1
150A-10		Pin spring	2
160-67S		Vacuum piston and pin assembly	1
160-91		Choke piston	1
170P-73S		Thermostatic coil and housing assembly	1
172-22		Throttle connector rod retainer	1
181-235S		Fast idle cam assembly	1
186-22		Baffle plate	1



# AMERICAN MOTORS PARTS CATALOG

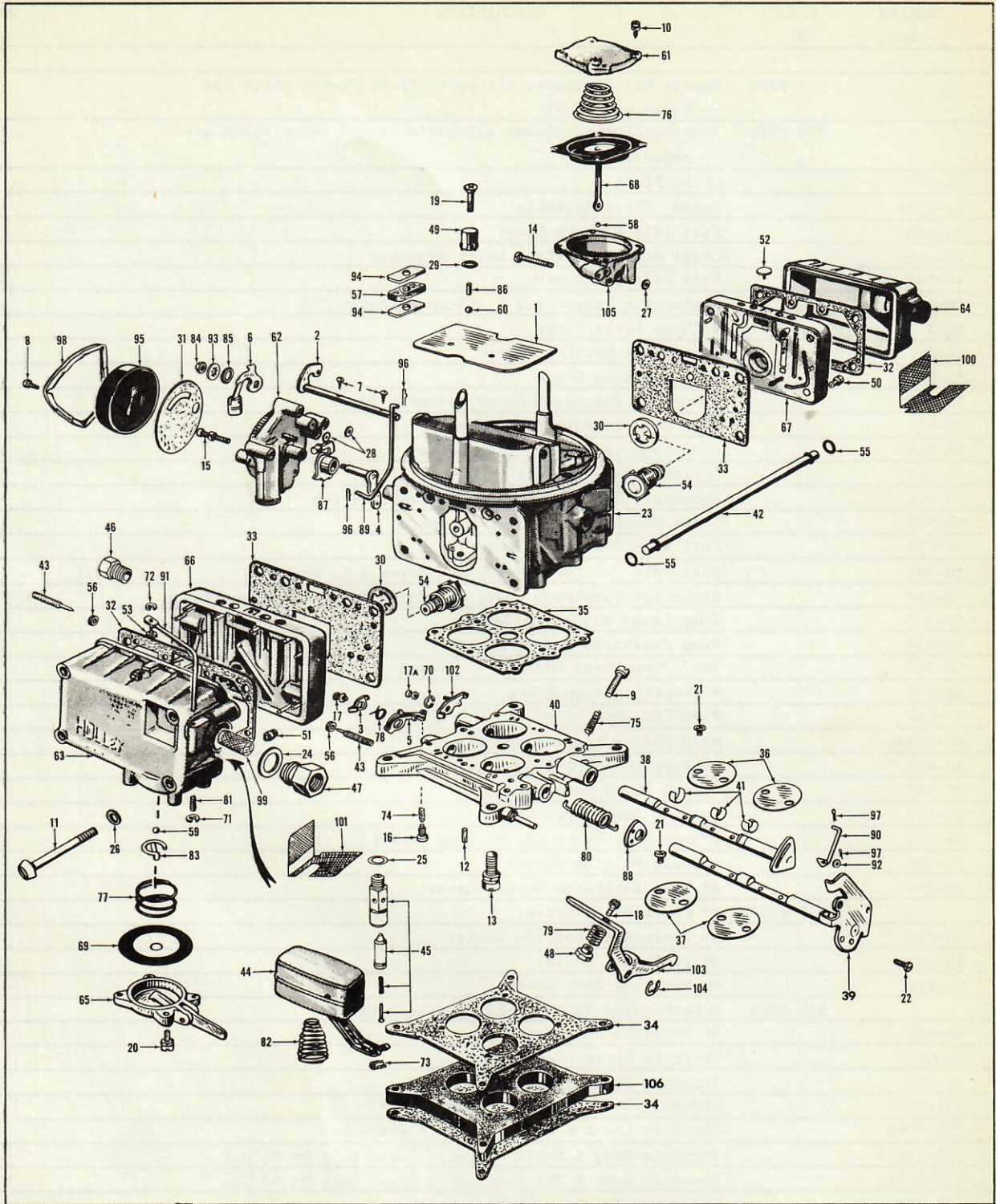

## CARBURETOR 59 20-80 (4 BARREL)

A.M.C. No. 315 5606  
 A.M.C. No. 315 3434

59 20  
 59 80

HOLLEY No. R-1748A And R-1748-1  
 HOLLEY NO. R-1312A And R-1312-1

320 2226 Pep Kit (Includes all parts listed below which are coded with a #)



# AMERICAN MOTORS PARTS CATALOG

KEY NO.	HOLLEY NO.	A.M.C. NO.	DESCRIPTION	QUAN. REQ.
		320 2223	Repair Kit (Includes all parts listed below which are coded with a *)	1
		320 2220	* Gasket Set (Includes all parts listed below which are coded with a +)	1
1	2R-278		Choke Plate	1
2	3R-278A		Choke Shaft Assembly	1
3	4R-485		Fast Idle Pick-Up Lever	1
4	4R-486A		Choke Housing Shaft & Lever Assembly	1
5	4R-568		Fast Idle Cam Lever	1
6	4R-547A		Thermostat Lever Link & Piston Assembly	1
7	5R-4		* Choke Plate Screw	2
8	5R-16		Thermostat Housing Screw	3
9	5R-155		Throttle Stop Screw	1
10	5R-370		Secondary Diaphragm Cover Assembly Screw	4
11	5R-552		Fuel Bowl to Main Body Screw	8
12	5R-565		Diaphragm Lever Adjusting Screw	1
13	5R-567		Throttle Body Screw & L. Washer	8
14	5R-568		Secondary Diaphragm Housing Assembly Screw	1
15	5R-569		Choke Housing Screw & L. Washer	3
16	5R-700		Fast Idle Adjusting Screw	1
17	5R-584		Fast Idle Cam Lever Retaining Screw & L. Washer	1
17A	5R-584		Secondary Diaphragm Lever Retaining Screw and Lock Washer	1
18	5R-595		Pump Lever Adjusting Screw	1
19	5R-614		Pump Discharge Nozzle Screw	1
20	5R-680		Fuel Pump Cover Screw & L. Washer	4
21	5R-635		* Throttle Plate Screw	8
22	5R-682		Pump Cam Lock Screw	1
23	6R-1333A		Main Body & Plugs Assembly	1
24	8R-482		#+ Fuel Inlet Fitting Gasket	1
25	8R-539		+ Fuel Valve Seat Gasket	2
26	8R-657		#+ Fuel Bowl Screw Gasket	8
27	8R-659		# Secondary Diaphragm Housing Gasket	1
28	8R-659		+ Choke Housing Gasket	2
29	8R-844		#+ Pump Discharge Nozzle Gasket	1
30		320 2204	#+ Power Valve Gasket	2
31	8R-686		#+ Thermostat Housing Gasket	1
32	8R-799		#+ Fuel Bowl Gasket	2
33	8R-814		#+ Metering Body Gasket	2
34		315 3819	# Carburetor To Manifold Insulator Gasket	2
35	8R-687		#+ Throttle Body Gasket	1
36	9R-96		Throttle Plate (Secondary)	2
37	9R-103		Throttle Plate (Primary)	2
38	10R-736A		Throttle Shaft Assembly (Secondary)	1
39	10R-724A		Throttle Lever & Shaft Assembly (Primary)	1
40	12R-1901A		Throttle Body & Shaft Assembly (Used Only On 59 80)	1
40	12R-2136A		Throttle Body & Shaft Assembly (Used Only On 59 20)	1
41	13R-490		Secondary Throttle Shaft Bushing	3
42	14R-320		Fuel Line Tubing	1
43		320 2206	* Idle Adjusting Needle	2
44		320 2208	Float & Hinge Assembly	2
45		320 2210	#* Fuel Valve & Seat Assembly	2
46	19R-74		Spark Fitting	1
47	19R-92		Fuel Inlet Fitting	1
48	19R-189		Pump Lever Adjusting Screw Fitting	1
49	21R-572-21		* Pump Discharge Nozzle	1
50	22R-40-35		* Main Jet (Secondary)	2



# AMERICAN MOTORS PARTS CATALOG

KEY NO.	HOLLEY NO.	A.M.C. NO.	DESCRIPTION	QUAN. REQ.
51	22R-40-49		* Main Jet (Primary)	2
52	23R-196		Bowl Vent Valve	1
53	23R-211		Air Vent Valve	1
54		320 2215	##* Power Valve Assembly	2
55		32Q 2216	##+ Fuel-Line Tube "O" Ring	2
56	27R-152		##+ Idle Needle Seal	2
57	27R-172		##+ Choke Rod Seal	1
58	28R-1		* Check Ball	1
59	28R-35		* Pump Check Ball	1
60	28R-94		* Pump Check Ball	1
61	34R-1334		Diaphragm Cover	1
62	34R-1529A		Choke Housing & Plugs Assembly	1
63	34R-2206A		Fuel Bowl & Plugs Assembly R.H.	1
64	34R-1695A		Fuel Bowl & Plugs Assembly L.H.	1
65	34R-2183A		Fuel Pump Cover Assembly	1
66	34R-1940A		Main Metering Body & Plugs Assembly (Primary)	1
67	34R-1942A		Main Metering Body & Plugs Assembly (Secondary)	1
68		320 2217	* Secondary Diaphragm Assembly	1
69		320 2219	##* Diaphragm Assembly	1
70	36R-164		* Secondary Diaphragm Link Retainer	1
71	36R-169		* Air Vent Rod Spring Retainer	1
72	36R-225		* Air Vent Valve Retainer	1
73	36R-236		* Float Retainer	2
74	38R-108		Fast Idle Adjusting Screw Spring	1
75	38R-110		Throttle Stop Screw Spring	1
76	38R-464		Secondary Diaphragm Spring	1
77	38R-569		Diaphragm Return Spring	1
78	38R-583		Fast Idle Cam Lever Spring	1
79	38R-587		Pump Lever Adjusting Screw Spring	1
80	38R-607		Throttle Return Spring	1
81	38R-615		Air Vent Rod Spring	1
82	38R-616		Float Spring	2
83	38R-635		* Pump Check Ball Retainer	1
84	39R-5		Choke Shaft Nut	1
85	40R-108		Choke Thermostat Lever Spacer	1
86	40R-336		Pump Check Ball Weight	1
87	41R-244A		Fast Idle Cam Assembly	1
88	41R-234		Pump Cam (Black)(Used Only On 59 80)	1
88	41R-240		Pump Cam (Red)(Used Only On 59 20)	1
89	43R-203		Choke Rod	1
90	43R-205		Throttle Connecting Rod	1
91	43R-219		Air Vent Push Rod	1
92	46R-25		Throttle Connecting Rod Washer	1
93	46R-248		Choke Shaft Nut L.W.	1
94	46R-463		Choke Rod Seal Washer	2
95	47R-116A		Thermostat Housing Assembly	1
96	48R-31		* Choke Rod Retainer	2
97	48R-183		* Throttle Connecting Rod Retainer	2
98	49R-328		Thermostat Housing Clamp	1
99	57R-28A		* Filter Screen Assembly	1
100	59R-29		Baffle Plate (Secondary)	1
101	59R-30		Baffle Plate (Primary)	1
102	63R-301A		Diaphragm Lever Assembly	1
103	63R-382		Pump Operating Lever	1
104	75R-37		* Pump Operating Lever Retainer	1
105	79R-389		Diaphragm Housing (Machine)	1
106		315 3820	Carburetor to Manifold Insulator	1



# AMERICAN MOTORS PARTS CATALOG

4.010

DESCRIPTION	YEAR AND MODEL	PER CAR	PART NO.
<b>GROUP 4 FUEL - EXHAUST</b>			
<b>4.001 CARBURETOR (Order Components From Local Jobber)</b>			
CARBURETOR (Carter YF-2757S).....	59 01.....	1	315 4345
(Holley R-1598A).....	59 10 (LDT).....	1	315 6267
(Holley R-1598-1A).....	59 10 (LDT).....	1	315 7563
(Carter WCD-2350S And WCD-2586S)....	59 10 (WDT).....	1	315 1207
(Carter WCD-2887S).....	59 10 (WDT).....	1	315 6695
(Holley R-1748-1).....	59 20.....	1	315 5606
(Holley R-1312-1).....	59 80.....	1	315 3434
ROD KIT, Metering (Incl. 1-5% Lean Rod Carter 75-793 And 1-10% Lean Rod Carter 75-794).....	59 01.....	1	313 2962
(Carter 75-1321U)(Incl. 2-3% Lean Rod Carter 75-1290, 2-6% Lean Rod Carter 75- 1291 And 2-9% Lean Rod Carter 75-1292)(For Use At 5000 Ft. Altitude).....	59 10 (WDT).....	1	314 9884
JET KIT, Main (Incl. 1-2 Sizes Lean Jet For 2000 To 5000 Ft. Altitude Holley 22R-40-57 And 1-4 Sizes Lean Jet For 500 To 10,000 Ft. Altitude Holley 22R-40-55)....	59 10 (LDT).....	1	315 6697
(Incl. 2-2 Sizes Lean Jet For 5000 To 8000 Ft. Altitude Holley 22R-40-47 And 2-4 Sizes Lean Jet For 10,000 Ft. Altitude Holley 22R-40-45)....	59 20-80.....	1	315 5925
PLUG.....	59 01-10-20-80.....	1	G444612
ELBOW, Fuel Pump To Carburetor Gasoline Tube...	59 01: 59 10 (WDT).....	1	G137422
CONNECTOR, Vacuum Line.....	59 01-20-80: 59 10 (WDT).....	1	G137404
ZIP FIT.....	59 01.....	1	320 2176
ZIP KIT.....	59 01.....	1	320 2174
	59 10 (WDT).....	1	320 2175
<b>4.004 GASKET - INSULATOR, Carburetor</b>			
GASKET.....	59 01 (2 Req.): 59 10 (LDT)(1 Req.).....	AR	315 3999
	59 10 (WDT).....	1	315 0679
	59 20-80.....	2	315 3819
INSULATOR.....	59 20-80.....	1	315 3820
<b>4.007 SPACER, Carburetor To Cylinder Head</b>			
SPACER.....	59 01.....	1	312 1704
<b>4.010 STUD, Carburetor To Cylinder Head Or Manifold Cover</b>			
STUD.....	59 01.....	2	313 5884
	59 10 (LDT).....	2	314 4808
	59 10 (WDT).....	2	315 0840
	59 20-80.....	4	G148090



(Long).....	59 10 (WDT).....	1	315 0832
(Short).....	59 10 (WDT).....	1	315 0831
WASHER.....	59 01.....	2	G138489
NUT.....	59 01: 59 10 (LDT).....	2	G124925
	59 10 (WDT): 59 20-80.....	4	G120368

## 4.020 TUBE, Carburetor Choke Heater

TUBE.....	59 01.....	1	313 7497
	59 10 (WDT).....	1	314 5538
(Use With Carburetor 3156267).....	59 10 (LDT).....	1	315 6449
(Use With Carburetor 3157563).....	59 10 (LDT).....	1	315 8092
(Left).....	59 20-80.....	1	315 3817
(Right).....	59 20-80.....	1	315 3818
Choke Manifold (3-7/8" Long).....	59 10.....	1	314 4673
(In Manifold).....	59 20-80.....	1	315 5604
PLUG, Hole (Large).....	59 20-80.....	1	315 0265
(Small).....	59 20-80.....	1	315 0266
SLEEVE (1/4" Ball Type).....	59 01-10-20-80.....	1	G114628
NUT (7/16-24)(1/4" Ball Type).....	59 01-10-20-80.....	1	G114627
ELBOW.....	59 20-80.....	1	315 3879

## 4.024 CABLE, Throttle Control (Fleet Sales Only)

CABLE (Incl. Button).....	59 10.....	1	315 5552
	59 20-80.....	1	315 5553
BRACKET.....	59 10-20-80.....	1	315 2926
ANCHOR.....	59 10.....	1	315 3392
	59 20-80.....	1	315 5555
PELLET.....	59 10-20-80.....	1	312 5873
CLIP.....	59 10 (2 Req.): 59 20-80 (1 Req.).....	AR	15 898
SCREW, Bracket To Dash.....	59 10-20-80.....	2	G431586
Clip.....	59 10-20-80.....	1	800 0093
Pellet.....	59 10-20-80.....	1	310 8350
NUT.....	59 10-20-80.....	1	G272123
Bracket To Dash.....	59 10-20-80.....	2	G120614
Anchor.....	59 20-80 (WST).....	2	G120613
WASHER (Lock).....	59 10-20-80.....	1	G114607
Bracket To Dash.....	59 10-20-80.....	2	G131096
(Plain), Bracket To Dash.....	59 10-20-80.....	2	G120391

## 4.040 PEDAL, Accelerator

PEDAL.....	59 01-10-20-80 (LHD).....	1	315 4567
	59 10-80 (RHD).....	1	312 3410
PIVOT.....	59 01-10-20-80.....	1	315 2572
EXTENSION.....	59 10-80 (RHD).....	1	313 1671
HINGE.....	59 10-80 (RHD).....	1	95 095
SPRING.....	59 10-80 (RHD).....	1	313 1861
Hinge Safety.....	59 01-10-20-80 (LHD).....	1	315 2608
SCREW, Hinge.....	59 10-80 (RHD).....	2	G445656
Extension.....	59 10-80 (RHD).....	2	G189618
WASHER (Lock), Extension Screw.....	59 10-80 (RHD).....	2	G131096
NUT, Extension Screw.....	59 10-80 (RHD).....	2	G120614
PIN, Hinge Clevis.....	59 10-80 (RHD).....	1	800 0221
Cotter.....	59 10-80 (RHD).....	1	G103362



# AMERICAN MOTORS PARTS CATALOG

4.055

## 4.045 ROD, Accelerator Pedal

ROD.....	59 01 (WST).....	1	315 4372
	59 01 (WOD)(WAT).....	1	315 4378
	59 10 (LHD).....	1	315 6121
	59 10-80 (RHD).....	1	315 3757
	59 20-80 (LHD).....	1	315 6210
CLIP, To Bellcrank.....	59 01-10-20-80 (LHD).....	1	313 6081
SEAL, Opening.....	59 01-10-20-80 (LHD).....	1	313 4126
WASHER (Plain).....	59 10-80 (RHD).....	2	800 0145
(Spring).....	59 10-80 (RHD).....	2	313 4115
PIN, Cotter.....	59 10-80 (RHD).....	2	G103361

## 4.050 BELLCRANK, Accelerator Pedal Rod

BELLCRANK.....	59 01.....	1	313 7004
	59 10 (LHD).....	1	315 6122
	59 10-80 (RHD).....	1	315 3763
LEVER (Upper).....	59 20-80 (LHD).....	1	315 3811
Switch Shaft.....	59 10-80 (RHD).....	1	315 3751
SHAFT.....	59 20-80 (LHD).....	1	315 6211
BRACKET, Mounting.....	59 10 (LHD).....	1	315 0199
To Manifold.....	59 20-80.....	1	315 0434
Shaft (Lower)(To Toeboard).....	59 20-80.....	1	315 0439
(Upper Support).....	59 20.....	1	315 2745
	59 80.....	1	315 3034
BEARING (Upper And Lower Bracket To Shaft).....	59 20-80.....	2	312 5552
STRAP, Shaft Upper Bracket To Toeboard.....	59 20-80.....	1	315 3632
SCREW, Bracket Mounting.....	59 10 (LHD).....	2	G179370
To Dash.....	59 20-80.....	3	800 0105
Upper Bracket To Support.....	59 20-80.....	1	G180018
Strap To Toeboard.....	59 20-80.....	2	800 0105
Strap To Bracket.....	59 20-80.....	1	G442279
WASHER (Plain)(11/32" x 11/16").....	59 01 (1 Req.): 59 10 (LHD)(2 Req.).....	AR	G120393
(11/32" x 7/8").....	59 10 (LHD).....	1	800 0153
Shaft (Right).....	59 10 (RHD)(2 Req.): 59 80 (RHD)(1 Req.).....	AR	800 0151
(Lower).....	59 20-80.....	2	800 0153
(Upper).....	59 20-80.....	1	G120393
Strap To Upper Brkt. Screw.....	59 20-80.....	1	G120391
(Lock), Upper Lever.....	59 10 (RHD): 59 20-80.....	1	G120380
Lever To Shaft.....	59 20-80.....	1	G120380
Shaft Strap To Bracket Screw....	59 20-80.....	1	G131096
(Spring).....	59 10 (LHD).....	1	314 7171
(Felt).....	59 10-20-80.....	2	313 4122
NUT, Upper Lever.....	59 10 (RHD): 59 20-80.....	1	G120375
Shaft Upper Support Bracket.....	59 20-80.....	1	G120375
Bracket Strap Screw.....	59 20-80.....	1	G120614
PIN, Shaft Cotter.....	59 10 (LHD): 59 20-80.....	2	G103361
Right Shaft Cotter.....	59 10 (RHD).....	1	G103361
Bracket Cotter.....	59 01.....	1	G103361

## 4.055 ROD, Accelerator Control

ROD.....	59 01.....	1	313 9804
	59 10 (LHD-LDT).....	1	315 6269
	59 10 (LHD-WDT).....	1	314 9851



# AMERICAN MOTORS PARTS CATALOG

(Crossover).....	59 10 (RHD-LDT).....	1	315 3822
	59 10 (RHD-WDT).....	1	315 3810
	59 80 (RHD).....	1	315 3756
CLIP, To Bellcrank.....	59 01.....	1	314 0386
Clevis.....	59 01.....	1	313 1561
Crossover Rod.....	59 10 (RHD-WDT).....	1	313 6081
	59 10 (RHD-LDT)(2 Req.): 59 10 (RHD-WDT)		
	(1 Req.).....	AR	313 4228
	59 80 (RHD).....	2	313 6081
To Control Shaft.....	59 10 (LHD-LDT).....	1	313 1562
	59 10 (LHD-WDT).....	1	313 1561
STUD, Control Rod Ball.....	59 10 (LHD).....	1	313 8271
4.070 SHAFT, Carburetor Control			
SHAFT.....	59 10 (LHD-WST-LDT).....	1	315 6270
	59 10 (LHD-WST-WDT).....	1	315 1462
	59 10 (LHD-WOD-LDT)(LHD-WAT-LDT).....	1	315 6271
	59 10 (LHD-WOD-WDT)(LHD-WAT-WDT).....	1	315 1463
	59 10 (RHD-LDT).....	1	315 6290
	59 10 (RHD-WDT).....	1	315 3809
	59 20.....	1	315 4273
	59 80 (LHD).....	1	315 3033
	59 80 (RHD).....	1	315 3759
BRACKET.....	59 10 (LHD).....	1	315 6272
(Right)(Front).....	59 10-80 (RHD).....	1	315 3755
(Rear).....	59 10-80 (RHD).....	1	315 3764
(Left).....	59 10 (RHD-LDT).....	1	315 6289
	59 10 (RHD-WDT).....	1	315 0674
BEARING.....	59 10 (LHD).....	1	312 5552
	59 10-80 (RHD).....	2	312 5552
PLATE, Bearing Retainer.....	59 10-80 (RHD).....	4	341 6915
END.....	59 20-80.....	1	648 0849
CONNECTION.....	59 10 (WDT).....	1	313 8268
CLAMP, Bearing Lubricating Washer.....	59 10 (LHD).....	1	312 8942
SPRING.....	59 20-80.....	1	314 3326
Front Shaft To Carburetor Connection....	59 10.....	1	72 447
PIN, Cotter.....	59 20-80.....	1	G103361
(To Connector Spring).....	59 10.....	1	G103362
(Bearing).....	59 80 (RHD).....	1	G103362
WASHER (Plain).....	59 20-80.....	2	G120392
	59 80 (RHD).....	1	800 0153
Bearing.....	59 80 (RHD).....	1	800 0151
To Connector Spring.....	59 10.....	1	800 0151
(Lock), Control Rod Ball Stud.....	59 10 (LHD).....	1	G131096
To Carburetor Connector.....	59 10 (WDT).....	2	G131095
Bearing Retainer Plate.....	59 10-80 (RHD).....	2	G131096
(Felt), Bearing Lubricating.....	59 10 (LHD).....	1	312 8941
SCREW, To Carburetor Connector.....	59 10 (WDT).....	2	G145530
Bracket.....	59 10-80 (RHD).....	3	800 0093
	59 10-80 (RHD).....	2	G145415
Bearing Retainer Plate.....	59 10-80 (RHD).....	2	G431942
LEVER, To Kickdown Switch.....	59 20-80 (WOD)(WAT).....	1	315 4268
NUT, End To Carburetor.....	59 20-80.....	1	G271169
Lock.....	59 20-80.....	2	G120613
Bearing Retainer Plate.....	59 10-80 (RHD).....	2	G120614
CLIP, To Control Rod.....	59 10 (LHD-LDT).....	1	313 1562
	59 10 (LHD-WDT).....	1	313 1561



# AMERICAN MOTORS PARTS CATALOG

4,124

## 4.080 SPRING, Carburetor Pull Back

SPRING.....	59 01-20-80: 59 10 (LHD).....	1	313 9296
	59 10 (RHD).....	1	314 3516
(Overtravel).....	59 10 (LHD-LDT).....	1	315 6377
	59 10 (LHD-WDT).....	1	314 0310
	59 10 (RHD).....	1	314 0310
BRACKET.....	59 10 (LHD-LDT).....	1	315 3673
	59 20-80.....	1	315 2746
ANCHOR.....	59 01.....	1	313 6722
SCREW, Bracket.....	59 10 (LHD-LDT).....	1	G179370
	59 20-80.....	2	800 0091

## 4.088 CLEANER, Carburetor Air

CLEANER (Dry).....	59 01.....	1	315 4526
	59 10 (LDT).....	1	315 6316
	59 20-80.....	1	315 3946
(Wet).....	59 01.....	1	315 4525
	59 10 (WDT).....	1	315 1308
	59 10 (LDT).....	1	315 3947
ELEMENT.....	59 01: 59 10 (LDT).....	1	899 0575
	59 20-80.....	1	899 0457
SEAL.....	59 20-80.....	1	320 1248
SLEEVE.....	59 10 (LDT).....	1	315 6315
STUD.....	59 20-80.....	1	315 3873
NUT, Wing (10-32).....	59 01: 59 10 (LDT).....	1	G148310
(1/4-20).....	59 10 (LDT).....	1	G148312
(1/4-20).....	59 20-80.....	1	315 1735
GASKET.....	59 10 (LDT).....	1	314 6126
BOLT, Retaining (With Wet Cleaner).....	59 01: 59 10 (WDT).....	1	320 1621

## 4.110 PUMP, Fuel (Order Components From Local Jobber)

PUMP (AC-5621658).....	59 01.....	1	315 5483
(Carter M-2379SA).....	59 10.....	1	315 2319
(Carter M-2433SA).....	59 20-80.....	1	315 2318
SCREW.....	59 01.....	2	G179822
	59 10.....	2	313 0125
	59 20-80.....	2	G180126
WASHER (Lock).....	59 01-10.....	2	G120214
	59 20-80.....	2	G120382

## 4.116 GASKET, Fuel Pump

GASKET.....	59 01-10-20-80.....	1	312 5674
-------------	---------------------	---	----------

## 4.118 ECCENTRIC, Camshaft Fuel Pump

ECCENTRIC.....	59 20-80.....	1	314 4449
BOLT.....	59 20-80.....	1	314 4704
WASHER, Retaining.....	59 20-80.....	1	314 4702
(Lock).....	59 20-80.....	1	G120384

## 4.124 ELBOW, Fuel Pump

ELBOW (Gas Line).....	59 01-10-20-80.....	2	G137422
(Vacuum Line).....	59 01 (WST)(WOD).....	1	G137421
	59 10-20-80.....	2	G137422



# AMERICAN MOTORS PARTS CATALOG

To W/S Wiper Tube.....	59 20-80.....	1	G137422
CONNECTOR (Vacuum Line).....	59 01.....	1	G137405
TEE (Vacuum Line).....	59 01 (WAT).....	1	G143482
CLIP, To Carburetor And W/S Wiper Tube.....	59 20-80.....	1	315 6574

## 4.130 TANK, Gasoline

TANK.....	59 01 (Note 4.130-1).....	1	315 6312
	59 01 (Note 4.130-2).....	1	315 7159
	59 10-20-80.....	1	315 6305

## 4.134 TUBE, Gasoline Tank Outlet

TUBE.....	59 01-10-20-80.....	1	315 1376
GASKET, Flange.....	59 01-10-20-80.....	1	313 2948
SCREW.....	59 01-10-20-80.....	2	314 3913

## 4.138 CAP, Gasoline Tank Filler

CAP (Less Ornament)(Painted).....	59 01.....	1	315 4523
	59 10-20-80.....	1	315 3626
(Chrome).....	59 10-20-80.....	1	315 3876
ORNAMENT.....	59 01-10-20-80.....	1	315 3627
SCREW (Incl. L/Washer).....	59 01-10-20-80.....	1	G188749

## 4.141 NECK, Gasoline Tank Filler

NECK.....	59 01.....	1	313 6642
(Incl. Air Vent Hose).....	59 10-20-80.....	1	315 6498
HOSE, Air Vent.....	59 10-20-80.....	1	315 6379
To Tank.....	59 01 (Note 4.130-1).....	1	313 6656
	59 01 (Note 4.130-2).....	1	315 7158
FLANGE.....	59 10-20-80.....	1	315 3374
SPACER, Flange.....	59 80 (Custom).....	1	315 5094
CLAMP.....	59 01.....	2	314 9267
	59 10-20-80.....	1	314 9267
Air Vent Hose.....	59 10-20-80.....	1	315 6382
SCREW, To Body.....	59 01-10-20-80.....	4	800 0093

## 4.148 FLANGE, Gasoline Tank Drain

FLANGE.....	59 01-10-20-80.....	1	313 4055
PLUG.....	59 01-10-20-80.....	1	313 4054
GASKET.....	59 01-10-20-80.....	1	313 4056

## 4.152 STRAP, Gasoline Tank

STRAP.....	59 01.....	1	312 8710
	59 10-20-80.....	1	314 5417
NUT (3/8 - 24).....	59 01 (2 Req.): 59 10-20-80 (1 Req.).....	AR	G120369
(1/2 - 20).....	59 10-20-80.....	1	G120370
WASHER (Plain)(13/32 x 13/16).....	59 01 (2 Req.): 59 10-20-80 (1 Req.).....	AR	G120394
(15/32 x 7/8).....	59 10-20-80.....	1	800 0179
(Lock)(3/8 x 11/16).....	59 01 (2 Req.): 59 10-20-80 (1 Req.).....	AR	G120382
(7/16 x 25/32).....	59 10-20-80.....	1	311 8257

NOTE 4.130-1: On 59 01 used prior to Serial No. M-51403.

NOTE 4.130-2: On 59 01 used beginning with Serial No. M-51403.



# AMERICAN MOTORS PARTS CATALOG

4.178

## 4.160 TUBE - HOSE, Gasoline Tank To Fuel Pump

TUBE, Tank To Hose And Connector.....	59 01.....	1	315 5857
	59 10.....	1	315 5784
	59 20-80.....	1	315 1615
Connector To Hose.....	59 20-80.....	1	315 5858
Fuel Pump To Hose.....	59 01-10-20-80.....	1	315 5856
HOSE, To Fuel Pump.....	59 01-10-20-80.....	2	315 5783
CLAMP, Hose.....	59 01-10-20-80.....	2	315 5854
CLIP, Gasoline And Brake Tube.....	59 10-20-80.....	3	312 6110
To Side Sill.....	59 01.....	5	47 272
	59 01-20-80.....	1	15 708
To Rear Floor Pan.....	59 10-20-80.....	1	15 708
On Crossmember.....	59 20.....	2	15 708
On Front Suspension Bracket.....	59 80.....	1	15 708
SCREW, Clip.....	59 10-80.....	2	800 0091
	59 20.....	3	800 0093
	59 20-80.....	1	800 0091
BOLT, Clip.....	59 80.....	1	G180020
NUT, Clip.....	59 80.....	1	G120375
WASHER (Plain).....	59 80.....	1	G120392
(Lock).....	59 80.....	1	G120380
(Rubber), Clip To Floor Pan.....	59 01.....	1	437 8249
CONNECTOR.....	59 20-80.....	1	G137414

## 4.174 TUBE, Fuel Pump To Carburetor

TUBE.....	59 01.....	1	315 5519
	59 10 (LDT).....	1	315 6450
	59 10 (WDT).....	1	314 6639
	59 20-80.....	1	315 3815
(Vacuum), Manifold To Fuel Pump.....	59 20-80.....	1	315 6572
To W/Shield Wiper.....	59 20-80.....	1	315 6573
CLIP.....	59 10.....	1	314 6527
BRACKET, Clip.....	59 10.....	1	314 6577
SCREW, Clip.....	59 10.....	1	800 0103
NUT, Screw Speed.....	59 10.....	1	313 4867

## 4.178 PIPE, Exhaust

PIPE.....	59 01.....	1	315 4575
	59 10.....	1	315 6250
(Left).....	59 20 (LDE).....	1	315 6275
	59 80 (LDE).....	1	315 6255
	59 20 (WDE).....	1	315 6106
	59 80 (LHD-WDE).....	1	315 6108
	59 80 (RHD-WDE).....	1	315 6649
(Right).....	59 20-80 (LDE).....	1	315 6256
	59 20 (WDE).....	1	315 6107
	59 80 (LHD-WDE).....	1	315 6109
	59 80 (RHD-WDE).....	1	315 6650
GLAND, Pipe To Manifold.....	59 20-80.....	2	315 5098
CLAMP, Pipe To Manifold.....	59 20-80 (LDE).....	1	315 5099
Right Exhaust Pipe To Left Exhaust Pipe (Incl. U-Bolt, Clamp, Nuts And Washers).	59 20-80 (LDE).....	1	313 1516



# AMERICAN MOTORS PARTS CATALOG

STUD, Exhaust Pipe To Manifold.....	59 10.....	3	315 6257
(Left).....	59 20-80.....	2	G441975
(Right).....	59 20-80.....	2	G103223
NUT, To Manifold Stud.....	59 10.....	3	314 9892
Clamp.....	59 20-80.....	4	314 9891
Clamp.....	59 20-80 (LDE).....	2	G120368
WASHER (Plain), Stud.....	59 10.....	3	800 0331
(Lock), Stud.....	59 10.....	3	G103321
Clamp.....	59 20-80.....	4	G103328
Clamp.....	59 20-80 (LDE).....	2	G120214
 4.186 CLAMP, Exhaust Pipe To Engine			
CLAMP.....	59 01.....	3	313 8796
HEATER, Choke Control.....	59 01.....	1	312 1786
 4.190 STUD, Exhaust Pipe To Engine			
STUD.....	59 01.....	6	313 5885
NUT.....	59 01.....	6	G120369
WASHER.....	59 01.....	6	800 0162
 4.195 BRACE - STRAP, Exhaust Pipe			
BRACE, To Transmission Case (Lower).....	59 01 (WST)(WOD).....	1	315 4637
(Upper).....	59 01 (WST)(WOD).....	1	315 4636
To Flywheel Housing.....	59 01 (WAT).....	1	315 4557
STRAP KIT (Incl. Clamp).....	59 20-80 (LDE-WAT).....	1	320 2080
(Incl. U-Bolt, Clamp, Nuts And Washers)..	59 01.....	1	313 0326
U-Bolt.....	59 01.....	1	313 0310
SCREW.....	59 20-80 (LDE-WAT).....	1	G181610
NUT.....	59 01 (2 Req.): 59 20-80 (LDE-WAT)(1 Req.)...	AR	G120368
WASHER (Lock).....	59 01 (2 Req.): 59 20-80 (LDE-WAT)(1 Req.)...	AR	G120214
(Plain).....	59 01.....	2	G120393
Clamp.....	59 20-80 (LDE-WAT).....	1	800 0153
 4.205 CLAMP, Exhaust Pipe To Muffler			
CLAMP (Incl. U-Bolt, Clamp, Nuts And Washers)..	59 01.....	1	313 0326
Clamp.....	59 10.....	1	102 211
Clamp.....	59 20-80 (LDE).....	1	314 3124
Clamp.....	59 20-80 (WDE).....	2	102 211
NUT.....	59 01-10: 59 20-80 (LDE).....	2	G120368
Clamp.....	59 20-80 (WDE).....	4	G120368
WASHER (Lock).....	59 01-10: 59 20-80 (LDE).....	2	G120214
Clamp.....	59 20-80 (WDE).....	4	G120214
 4.210 MUFFLER			
MUFFLER.....	59 01.....	1	315 6526
Clamp.....	59 10.....	1	315 6251
Clamp.....	59 20-80 (LDE).....	1	315 6219
Clamp.....	59 20-80 (WDE).....	2	315 6528
 4.227 PIPE, Tail			
PIPE.....	59 04.....	1	315 6510
Clamp.....	59 02-06 (LWC).....	1	315 6511



# AMERICAN MOTORS PARTS CATALOG

4.234

	59 02-06 (WWC).....	1	315 6512
	59 15-19 (LWC).....	1	315 6518
	59 15-19 (WWC).....	1	315 6520
	59 18.....	1	315 6516
	59 25-29-85-89 (LDE-LWC).....	1	315 6258
	59 25-29-85-89 (LDE-WWC).....	1	315 6260
	59 28-83-88 (LDE).....	1	315 6417
(Left).....	59 25-29-85-89 (LHD-WDE-LWC).....	1	315 6518
	59 25-29-85-89 (LHD-WDE-WWC).....	1	315 6520
	59 28-83-88 (LHD): 59 80 (RHD).....	1	315 6516
(Right).....	59 25-29-85-89 (LHD-WDE-LWC).....	1	315 6519
	59 25-29-85-89 (LHD-WDE-WWC).....	1	315 6521
	59 28-83-88 (LHD-WDE).....	1	315 6517
	59 80 (RHD-WDE).....	1	315 6522

## 4.230 CLAMP, Muffler To Tail Pipe

CLAMP (Incl. U-Bolt, Clamp, Nuts And Washers)...	59 01.....	1	313 0327
	59 10 (1 Req.): 59 20-80 (WDE)(2 Req.).....	AR	313 0326
	59 20-80 (LDE).....	1	102 211
NUT.....	59 01-10: 59 20-80 (LDE).....	2	G120368
	59 20-80 (WDE).....	4	G120368
WASHER (Lock).....	59 01-10: 59 20-80 (LDE).....	2	G120214
	59 20-80 (WDE).....	4	G120214

## 4.234 SUPPORT, Tail Pipe

SUPPORT (Front).....	59 01.....	1	315 4535
(Rear).....	59 01-10: 59 20-80 (LDE).....	1	315 6588
	59 20-80 (WDE).....	2	315 6588
(Incl. Vibration Damper)(Front Left)...	59 10-20-80.....	1	315 6675
(Front Right)...	59 20-80 (WDE).....	1	315 6676
HOSE, Vibration Damper.....	59 10: 59 20-80 (LDE).....	1	315 6674
	59 20-80 (WDE).....	2	315 6674
ROD, Vibration Damper Hose.....	59 10: 59 20-80 (LDE).....	1	315 6673
	59 20-80 (WDE).....	2	315 6673
INSULATOR.....	59 10: 59 20-80 (LDE).....	1	315 1408
	59 20-80 (WDE).....	2	315 1408
BRACKET (Rear)(On Bumper Bolt).....	59 04-18: 59 28-83-88 (LDE).....	1	313 3085
	59 15-19: 59 25-29-85-89 (LDE).....	1	315 3953
	59 28-83-88 (WDE).....	2	313 3085
	59 25-29-85-89 (WDE).....	2	315 3953
CLAMP (Incl. U-Bolt, Clamp, Nuts And Washers)			
(Front).....	59 01.....	1	313 0327
	59 10 (1 Req.): 59 20-80 (WDE)(2 Req.).....	AR	313 0326
	59 20-80 (LDE).....	1	102 211
(Incl. Bolt, Clamp, Nut And Washer)			
(Rear).....	59 01.....	1	312 3193
	59 10 (1 Req.): 59 20-80 (WDE)(2 Req.).....	AR	315 2556
	59 20-80 (LDE).....	1	315 6237
BOLT, Front Support To Floor Pan.....	59 01.....	1	G181596
	59 10: 59 20-80 (LDE).....	1	G181595
	59 20-80 (WDE).....	2	G181595
Rear Support To Body.....	59 01 (LWC).....	1	G181595
Bracket.....	59 04-10: 59 20-80 (LDE).....	1	G181595
	59 20-80 (WDE).....	2	G181595
Clamp.....	59 01-10: 59 20-80 (LDE).....	1	G181614
	59 20-80 (WDE).....	2	G181614



# AMERICAN MOTORS PARTS CATALOG

Hanger.....	59 01 (WWC).....	1	G181614
Vibration Damper Hose.....	59 10: 59 20-80 (LDE).....	1	G181614
	59 20-80 (WDE).....	2	G181614
NUT, Front Support U-Bolt.....	59 01-10: 59 20-80 (LDE).....	2	G120368
	59 20-80 (WDE).....	4	G120368
Rear Support Clamp.....	59 01-10: 59 20-80 (LDE).....	1	G120368
	59 20-80 (WDE).....	2	G120368
To Bracket Bolt.....	59 04-10: 59 20-80 (LDE).....	1	G120368
Vibration Damper Hose.....	59 20-80 (WDE).....	2	G120368
	59 10-20-80.....	AR	G442826
WASHER, Support To Insulator.....	59 10-20-80.....	AR	314 2090
(Plain), Hanger Spacer.....	59 01.....	3	800 0155
(Lock), Front Support U-Bolt.....	59 01-10: 59 20-80 (LDE).....	2	G120214
	59 20-80 (WDE).....	4	G120214
Support To Floor Pan Bolt	59 01-10.....	1	G120214
Rear Support Clamp.....	59 20-80 (WDE).....	4	G120214
	59 01-10: 59 20-80 (LDE).....	2	G120214
Support Bolt.....	59 01 (LWC).....	1	G120214
To Bracket Screw..	59 04-10: 59 20-80 (LDE).....	1	G120214
	59 20-80 (WDE).....	2	G120214